

**表 1 - 圓錐度及平圓錐度**

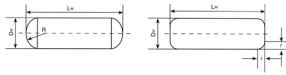

平均圓錐度				
系統標準設計平均圓錐度的公差代碼				
公差代碼				
公差代碼				
公差代碼				
1	2	3	4	5
0.1	0.1	0.1	0.1	0.1
0.1	0.1	0.1	0.1	0.1
0.1	0.1	0.1	0.1	0.1
0.1	0.1	0.1	0.1	0.1

平均圓錐度公差				
公差代碼				
公差代碼				
公差代碼				
公差代碼				
1	2	3	4	5
0.1	0.1	0.1	0.1	0.1
0.1	0.1	0.1	0.1	0.1
0.1	0.1	0.1	0.1	0.1
0.1	0.1	0.1	0.1	0.1

Lw	公差代碼				
	1	1.5	2	2.5	3
3.0	x	x			
4.0	x	x			
5.0	x	x			
6.0	x	x			
7.0	x	x			
8.0	x	x			
9.0	x	x			
10.0	x	x			
11.0	x	x			
12.0	x	x			
13.0	x	x			
14.0	x	x			
15.0	x	x			
16.0	x	x			
17.0	x	x			
18.0	x	x			
19.0	x	x			
20.0	x	x			
21.0	x	x			
22.0	x	x			
23.0	x	x			
24.0	x	x			
25.0	x	x			
26.0	x	x			
27.0	x	x			
28.0	x	x			
29.0	x	x			
30.0	x	x			
31.0	x	x			
32.0	x	x			
33.0	x	x			
34.0	x	x			
35.0	x	x			
36.0	x	x			
37.0	x	x			
38.0	x	x			
39.0	x	x			
40.0	x	x			

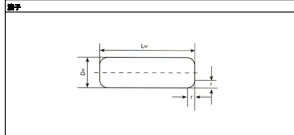

公差代碼	公差代碼		公差代碼	
	Dw	Lw	公差代碼	公差代碼
3.0x3.0	3	3		
3.0x4.0	3	5		
3.0x5.0	3.5	5		
4.0x4.0	4	4		
4.0x6.0	4	6		
4.0x8.0	4	8		
4.5x4.5	4.5	4.5		
4.5x6.0	4.5	6		
5.0x5.0	5	5		
5.0x8.0	5	8		
5.0x10.0	5	10		
5.5x5.5	5.5	5.5		
5.5x8.0	5.5	8		
6.0x6.0	6	6		
6.0x8.0	6	8		
6.0x10.0	6	10		
6.0x12.0	6	12		
6.5x6.5	6.5	6.5		
6.5x9.0	6.5	9		
7.0x7.0	7	7		
7.0x10.0	7	10		
7.0x14.0	7	14		
7.5x7.5	7.5	7.5		
7.5x9.0	7.5	9		
7.5x11	7.5	11		
8.0x8.0	8	8		
8.0x10.0	8	10		
8.0x12.0	8	12		
9.0x9.0	9	9		
9.0x10.0	9	10		
9.0x14.0	9	14		
10 x 10.0	10	10		
10 x 11.0	10	11		
10 x 14.0	10	14		
11 x 11.0	11	11		
11 x 12.0	11	12		
11 x 15.0	11	15		
12 x 12.0	12	12		
12 x 14.0	12	14		
12 x 18.0	12	18		
13 x 13.0	13	13		
13 x 20.0	13	20		
14 x 14.0	14	14		
14 x 20.0	14	20		
15 x 15.0	15	15		
15 x 16.0	15	16		
15 x 20.0	15	20		
16 x 16.0	16	16		
16 x 17.0	16	17		
16 x 24.0	16	24		
17 x 17.0	17	17		
17 x 24.0	17	24		
18 x 18.0	18	18		
18 x 19.0	18	19		
18 x 26.0	18	26		
19 x 19.0	19	19		
19 x 20.0	19	20		
19 x 26.0	19	26		
20 x 20.0	20	20		
20 x 30.0	20	30		
21 x 21.0	21	21		
21 x 30.0	21	30		
22 x 22.0	22	22		
22 x 24.0	22	24		
22 x 30.0	22	30		
23 x 23.0	23	23		
23 x 30.0	23	30		
24 x 24.0	24	24		
24 x 30.0	24	30		
24 x 36.0	24	36		
25 x 25.0	25	25		
25 x 36.0	25	36		
26 x 26.0	26	26		
26 x 28.0	26	28		
26 x 40.0	26	40		
28 x 28.0	28	28		
28 x 44.0	28	44		
30 x 30.0	30	30		
30 x 40.0	30	40		
32 x 32.0	32	32		
32 x 52.0	32	52		
34 x 34.0	34	34		
34 x 52.0	34	52		
36 x 36.0	36	36		
36 x 58.0	36	58		
38 x 38.0	38	38		
38 x 62.0	38	62		
40 x 40.0	40	40		
40 x 65.0	40	65		
42 x 42.0	42	42		
45 x 45.0	45	45		
48 x 48.0	48	48		
50 x 50.0	50	50		